

Microsoft

Exam Questions AB-730

AI Business Professional



NEW QUESTION 1

You plan to summarize a proposal for a partnership between your company and another company. You need to use Microsoft 365 Copilot to summarize the information in the proposal as a bulleted list of three to five key points for a project kickoff meeting. Each bullet point must be concise and simply worded. Which two details should you include in the prompt?

- A. profiles of both companies generated by using the Researcher agent
- B. concise instructions for what to do with the proposal
- C. a list of contact details for key stakeholders of the partnership
- D. a specific knowledge source to ground the response

Answer: BD

Explanation:

Effective prompting in Microsoft 365 Copilot requires two critical components: clear instructions and grounding in authoritative content. Microsoft guidance emphasizes that prompts should explicitly state the desired output format, tone, length, and purpose. In this case, specifying "a bulleted list of three to five concise, simply worded key points" represents concise instructions, making option B essential. Additionally, grounding the response in a specific knowledge source—such as attaching or referencing the proposal document—ensures factual accuracy and reduces hallucination. Option D ensures Copilot uses the actual proposal content rather than relying on generalized model knowledge. Profiles and stakeholder contact details are unrelated to summarization requirements. Therefore, the correct selections are B and D.

=====

NEW QUESTION 2

A colleague from another company shares a link to a prompt. When you select the link, you receive the following response: "Prompt not found. Sorry, it looks like the prompt is no longer available." What is a possible cause of the response?

- A. The prompt is a scheduled prompt.
- B. The prompt contains a reference to a file that you do NOT have access to.
- C. The prompt is outdated.
- D. The prompt contains a file that has a sensitivity label applied.
- E. The prompt is outside of your organization.

Answer: E

Explanation:

Microsoft 365 Copilot operates within the security, compliance, and identity boundaries of a Microsoft 365 tenant. Shared prompts, prompt links, and Copilot artifacts are governed by organizational access controls and tenant isolation. If a prompt is created and shared from outside your organization, cross-tenant access may not be supported depending on the sharing configuration and administrative policies. When a user attempts to open a prompt that resides in another organization's tenant without proper cross-tenant sharing permissions, Copilot cannot locate or validate the resource within the user's own environment. As a result, the system displays a "Prompt not found" message. Option B would typically result in an access or permissions error rather than the prompt being unavailable entirely. Sensitivity labels and scheduled prompts do not inherently cause a "not found" error. Therefore, the most likely cause is that the prompt exists outside your organization's tenant boundary and is not accessible to you.

=====

NEW QUESTION 3

You are creating a prompt in Microsoft 365 Copilot to get information about a proposal. You need to ensure that the response is grounded in the proposal's information. What is the best approach to achieve the goal? More than one answer choice may achieve the goal. Select the BEST answer.

- A. Instruct Copilot to rely on its training data to infer proposal details.
- B. Add a specific goal that you want Copilot to accomplish.
- C. Reference the proposal content in the prompt.
- D. Add context about the intended audience.

Answer: C

Explanation:

According to Microsoft AI Business Professional guidance for Microsoft 365 Copilot, grounding a response means ensuring the AI generates output based on specific, authoritative content rather than relying on generalized training data. When working with enterprise documents such as proposals, grounding is achieved by explicitly referencing the source material within the prompt. Option C is correct because referencing the proposal content directs Copilot to use that specific document as the primary context for generating the response. Microsoft documentation emphasizes that effective prompts should include clear context and explicit references to relevant files, meetings, emails, or documents stored in Microsoft 365. This reduces hallucinations and ensures factual alignment with organizational data. Option A is incorrect because relying on training data increases the risk of inaccurate or fabricated information. Options B and D improve prompt clarity but do not guarantee grounding in the proposal itself. Therefore, explicitly referencing the proposal content is the most reliable and best practice method for ensuring grounded, accurate responses in Microsoft 365 Copilot.

NEW QUESTION 4

You use the Researcher agent in Microsoft 365 Copilot to generate a report. What can you use to verify whether the report was generated by using valid sources?

- A. citations
- B. instructions
- C. memory
- D. capabilities

Answer: A

Explanation:

The Researcher agent in Microsoft 365 Copilot is designed to gather and synthesize information from web and organizational sources. To support transparency and trust, Copilot provides citations alongside generated content when external or referenced material is used. Citations allow users to review the original sources that informed the generated report. This aligns with Microsoft's Responsible AI commitment to transparency and verifiability. By selecting or reviewing citations, users can confirm that the information originates from credible and relevant references rather than unsupported model-generated text. Instructions define how the agent behaves but do not validate source authenticity. Memory refers to conversational context retention and does not confirm source validity. Capabilities describe what the agent can do, not whether its output is grounded in legitimate sources. Therefore, to verify that a report generated by the Researcher agent uses valid sources, you should review the citations.

NEW QUESTION 5

Select the answer that correctly completes the sentence.

Answer Area

Overreliance is a common risk associated with generative AI, where

users exploit vulnerabilities to elicit unauthorized behavior.

the model is tricked into exposing confidential information.

the model generates misleading, inaccurate, or irrelevant content.

users accept the AI-generated output without verifying its accuracy

- A. Mastered
- B. Not Mastered

Answer: A

Explanation:

Answer Area

Overreliance is a common risk associated with generative AI, where

users exploit vulnerabilities to elicit unauthorized behavior.

the model is tricked into exposing confidential information.

the model generates misleading, inaccurate, or irrelevant content.

users accept the AI-generated output without verifying its accuracy

NEW QUESTION 6

You create a prompt in Microsoft 365 Copilot to help you create a draft project report. You need the prompt to be available in the Copilot Prompt Gallery. What should you do first?

- A. Create a noteboo
- B. Add an agen
- C. Create a pag
- D. Run the prompt.

Answer: D

Explanation:

To add a custom prompt to the Microsoft 365 Copilot prompt gallery, type your prompt in the chat, click the "Save prompt" (bookmark) icon that appears after the response, and title it for future use. Access the gallery via the "View Prompts" icon in the chat pane to manage or share your saved prompts.

Reference:

<https://www.youtube.com/watch?v=BkjK2ZISS1A>

NEW QUESTION 7

You sign in to the Microsoft 365 Copilot app by using your work account as shown in the following exhibit

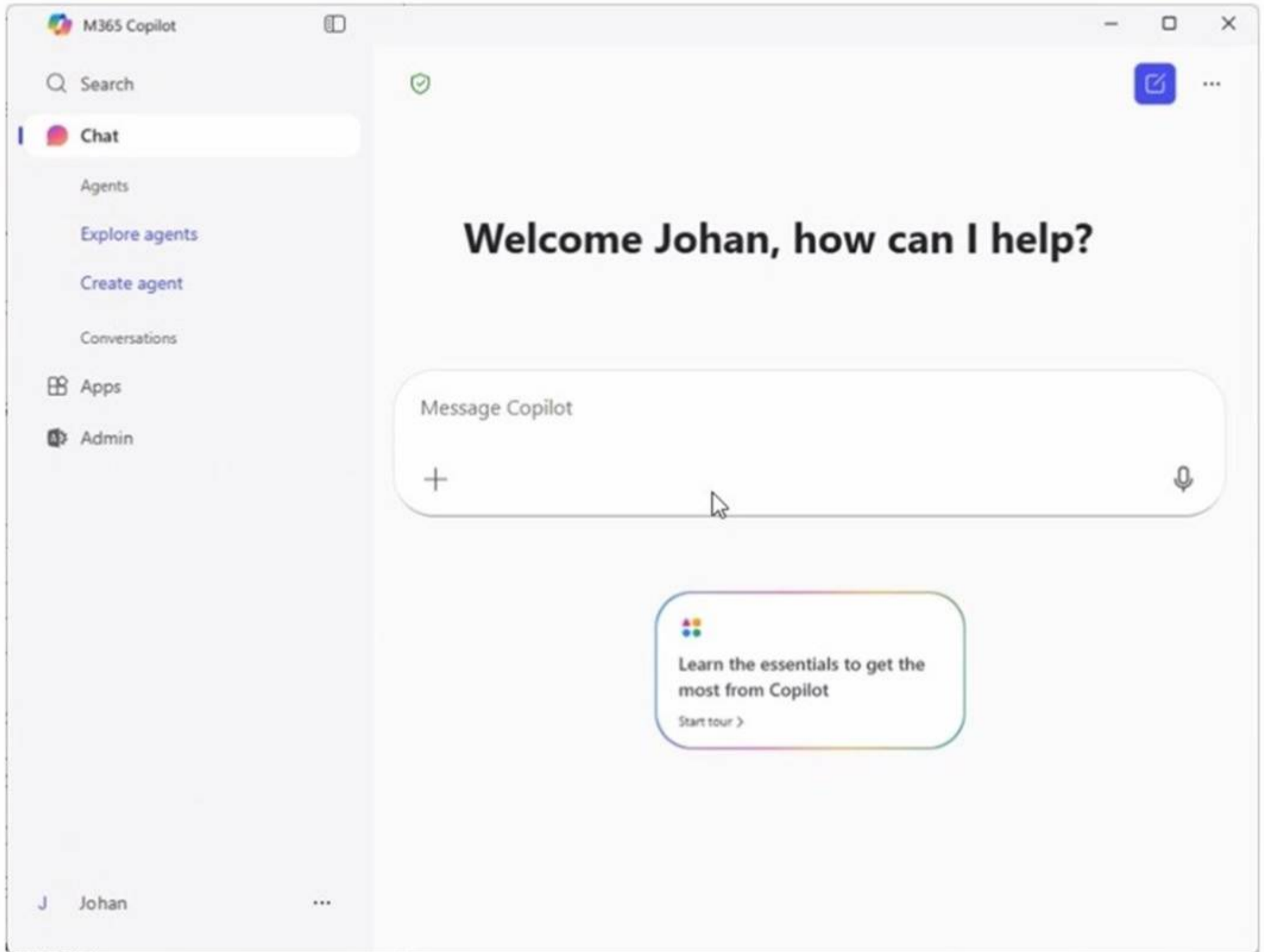

A colleague tells you that when they open the Microsoft 365 Copilot app, they have access to the Researcher agent. You need to access to the Researcher agent. What should you do?

- A. From Microsoft Edge, use your work account to sign in to <https://copilot.microsoft.com>.
- B. Select Explore agents and then search for Researcher.
- C. Sign in to the Copilot app by using a personal account
- D. Request a Microsoft 365 Copilot license from an administrator.

A.

Answer: B

NEW QUESTION 8

You are creating a custom analytics agent in the Microsoft 365 Copilot app. The agent will use Microsoft Excel files that contain sales data as knowledge. You need to ensure that the agent can create visualizations, perform mathematical operations, create aggregations, and analyze the data in the files. What should you add to the agent?

- A. code interpreter
- B. image generator
- C. a suggested prompt
- D. a template

A.

Answer: A

Explanation:

When building a custom analytics agent in Microsoft 365 Copilot that must process structured data from Excel files, advanced analytical capabilities are required. According to Microsoft AI Business Professional guidance, tasks such as performing mathematical calculations, generating aggregations, creating charts, and conducting structured data analysis require programmatic execution capabilities rather than simple text generation.

A code interpreter enables the agent to run Python-based analytical operations in a secure execution environment. This allows the agent to manipulate datasets, compute totals and averages, perform grouping and filtering, and generate visualizations such as bar charts or line graphs based on the Excel data. The interpreter bridges the gap between natural language instructions and executable analytical logic.

An image generator is designed for creative visual content and is unrelated to structured data analytics. Suggested prompts and templates improve usability and consistency but do not provide computational or visualization capabilities.

Therefore, to enable mathematical operations, aggregation, data analysis, and visualization of Excel sales data, the correct component to add to the agent is a code interpreter.

NEW QUESTION 9

You use Microsoft 365 Copilot to create a proposal in Microsoft Word based on a document in a Microsoft SharePoint library. You need to ensure that the information cited in the proposal is accurate. What is the best approach to achieve the goal? More than one answer choice may achieve the goal. Select the BEST answer.

- A. Manually verify the citations in the generated content.
- B. Use Copilot in Word to verify the citations.
- C. Create an agent that contains your organization's editorial standards and use the agent to verify the citations.
- D. Create a notebook that contains all the reference material and use the notebook to verify the citations.

Answer: A

NEW QUESTION 10

HOTSPOT

Select the answer that correctly completes the sentence.

Answer Area

If you start a temporary chat in Microsoft 365 Copilot, and then start a new chat, all the prompts and responses from the temporary chat will be

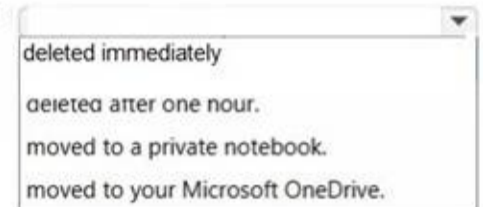

- A. Mastered
- B. Not Mastered

Answer: A

Explanation:

Answer Area

If you start a temporary chat in Microsoft 365 Copilot, and then start a new chat, all the prompts and responses from the temporary chat will be

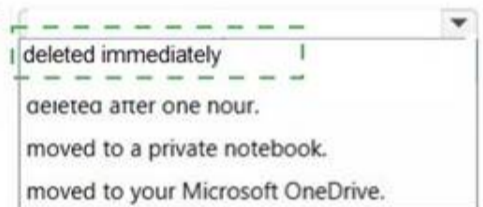

NEW QUESTION 10

You sign in to the Microsoft 365 Copilot app by using your work account as shown in the exhibit. A colleague tells you that when they open the Microsoft 365 Copilot app, they have access to the Researcher agent. You need to access the Researcher agent. What should you do?

- A. From Microsoft Edge, use your work account to sign in to <https://copilot.microsoft.com>.
- B. Select Explore agents and then search for Researcher.
- C. Sign in to the Copilot app by using a personal account.
- D. Request a Microsoft 365 Copilot license from an administrator.

Answer: B

NEW QUESTION 15

HOTSPOT

For each of the following statements, select Yes if the statement is true. Otherwise, select No. NOTE: Each correct selection is worth one point.

Answer Area

Statements	Yes	No
Microsoft 365 Copilot is trained on your organization's business data.	<input type="radio"/>	<input type="radio"/>
Microsoft 365 Copilot can summarize emails in mailboxes that were shared with you.	<input type="radio"/>	<input type="radio"/>
Microsoft 365 Copilot leverages the security framework defined in Microsoft 365 to provide you with access to emails, documents, and other enterprise data.	<input type="radio"/>	<input type="radio"/>

- A. Mastered
- B. Not Mastered

Answer: A

Explanation:

Answer Area

Statements

Microsoft 365 Copilot is trained on your organization's business data.

Yes

No

Microsoft 365 Copilot can summarize emails in mailboxes that were shared with you.

Microsoft 365 Copilot leverages the security framework defined in Microsoft 365 to provide you with access to emails, documents, and other enterprise data.

NEW QUESTION 18

You are using Microsoft 365 Copilot to enhance your productivity in Microsoft Teams. Which two tasks can you achieve by using Copilot in Teams? Each correct answer presents a complete the solution. NOTE: Each correct selection is worth one point.

- A. Mute and unmute participants in a meeting based on their location.
- B. Create a custom background and add the background to your video calls.
- C. Create a meeting summary, including key decisions and action items.
- D. Draft a response to a channel message based on the context of the conversation.

Answer: CD

NEW QUESTION 19

HOTSPOT

You have a Microsoft 365 subscription. You do NOT have a Microsoft 365 Copilot license. For each of the following statements, select Yes if the statement is true. Otherwise, select No. NOTE: Each correct selection is worth one point.

Answer Area

Statements

Microsoft 365 Copilot Chat lets you upload documents from your local computer.

Yes

No

Microsoft 365 Copilot Chat is included with Microsoft 365 Business Standard.

Microsoft 365 Copilot Chat lets you create and use agents that can access Microsoft SharePoint folders.

- A. Mastered
- B. Not Mastered

Answer: A

Explanation:

Answer Area

Statements

Microsoft 365 Copilot Chat lets you upload documents from your local computer.

Yes

No

Microsoft 365 Copilot Chat is included with Microsoft 365 Business Standard.

Microsoft 365 Copilot Chat lets you create and use agents that can access Microsoft SharePoint folders.

NEW QUESTION 22

.....

Thank You for Trying Our Product

We offer two products:

1st - We have Practice Tests Software with Actual Exam Questions

2nd - Questions and Answers in PDF Format

AB-730 Practice Exam Features:

- * AB-730 Questions and Answers Updated Frequently
- * AB-730 Practice Questions Verified by Expert Senior Certified Staff
- * AB-730 Most Realistic Questions that Guarantee you a Pass on Your FirstTry
- * AB-730 Practice Test Questions in Multiple Choice Formats and Updatesfor 1 Year

100% Actual & Verified — Instant Download, Please Click
[Order The AB-730 Practice Test Here](#)